

0816

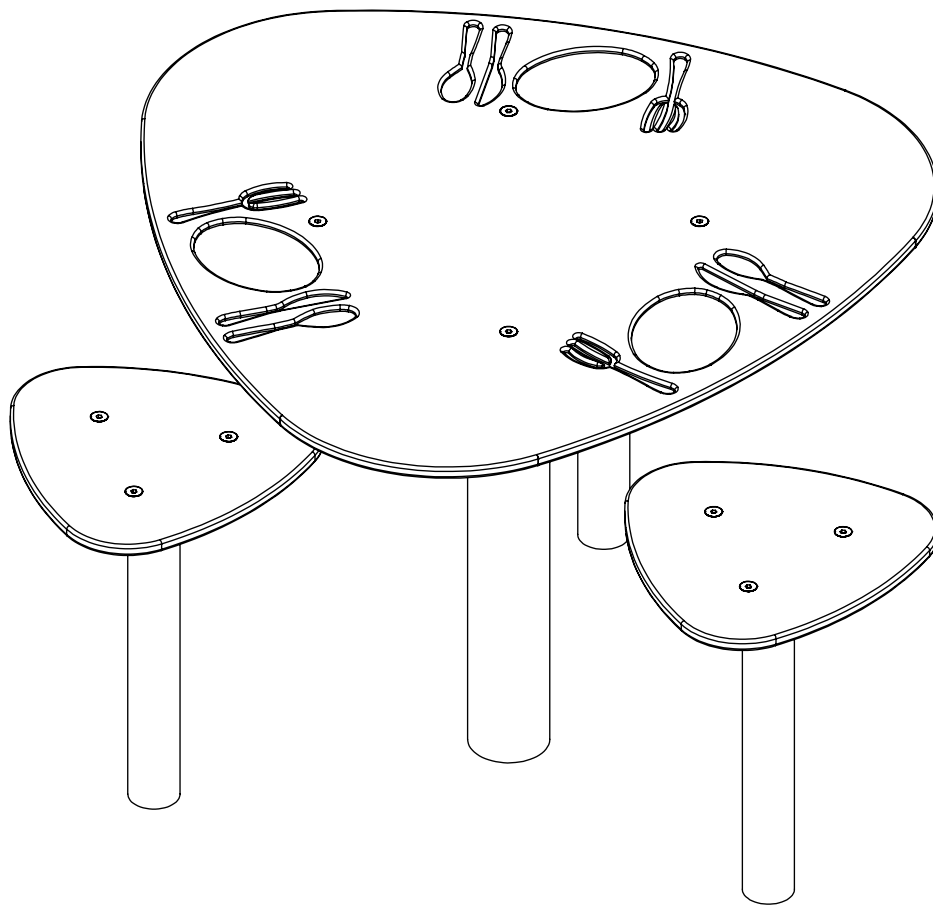

[cm]
v012
25.11.2021
W.G.



2,0h



K1
x4
>0,06m³

K2
x4
>0,02m³

K3
x1
>0,24m³

48h

<60
HIC



play
vinici

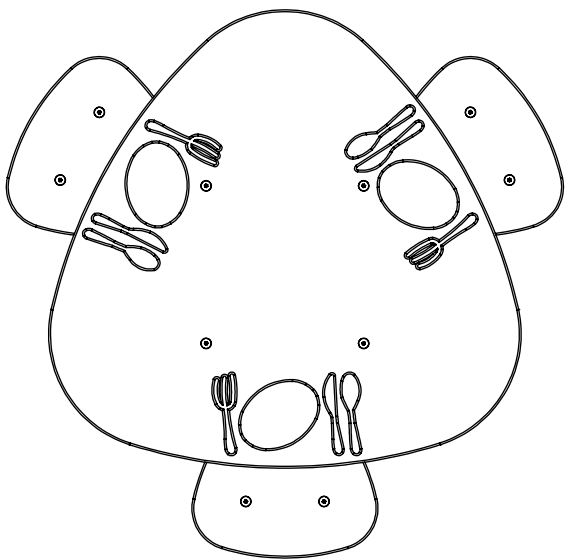
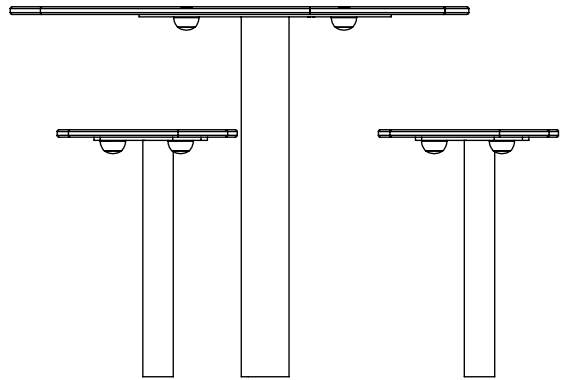
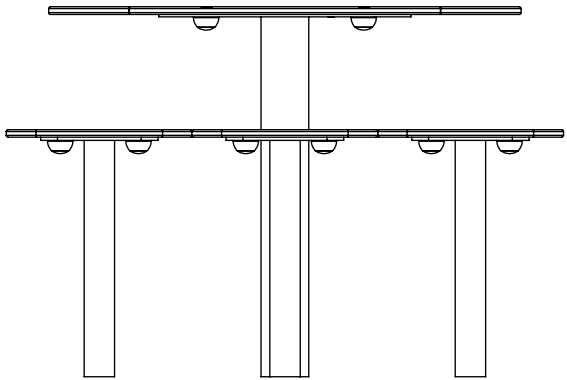

[cm]

play
vinci

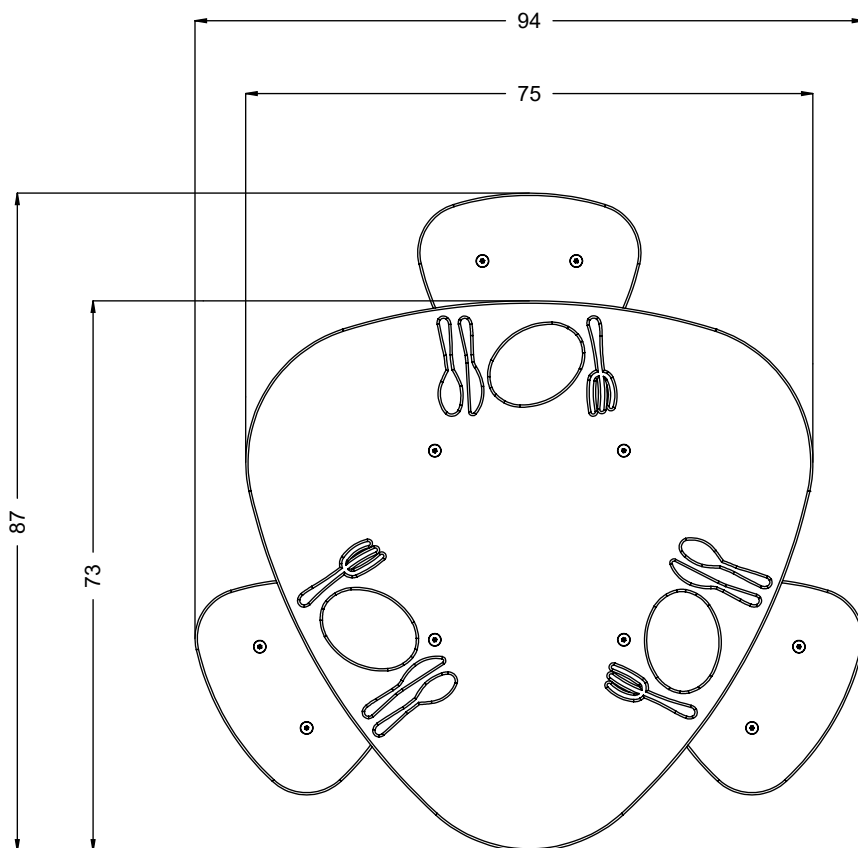
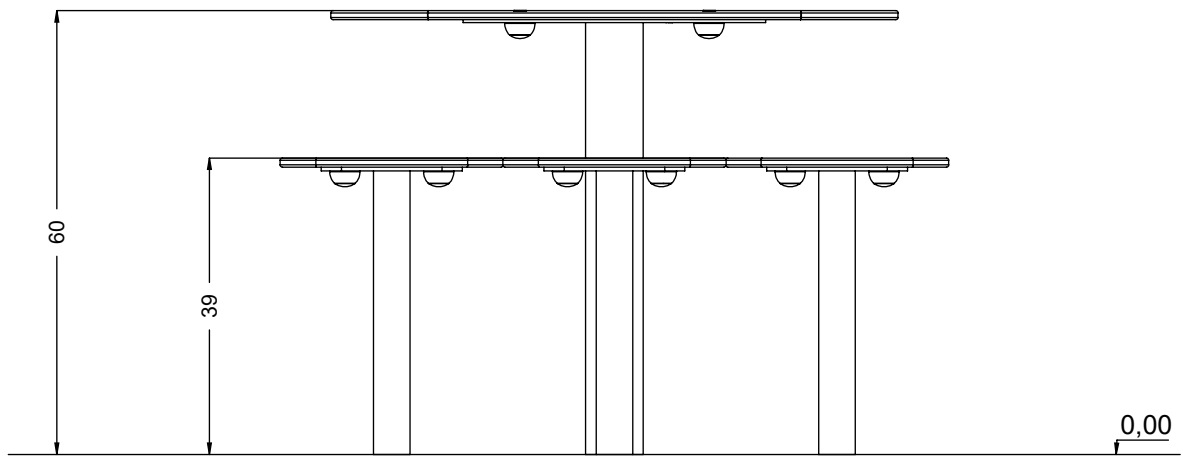

[cm]



play
Vinci

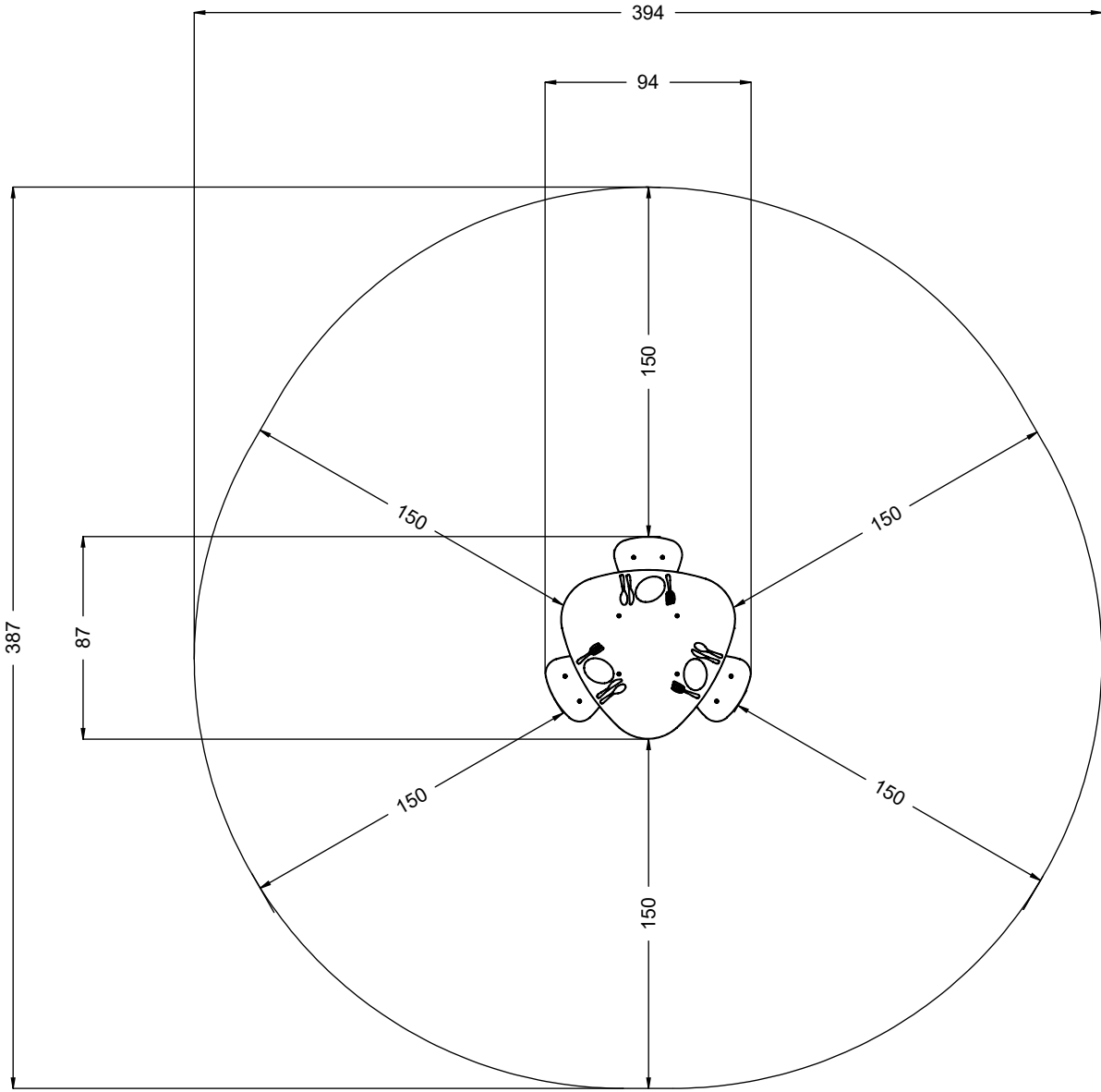

[cm]



play
Vinci

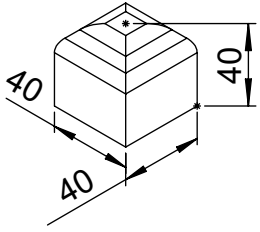

A.

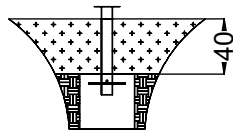

B.

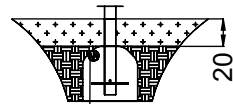

C.

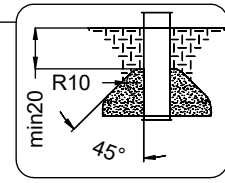
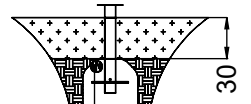

K1

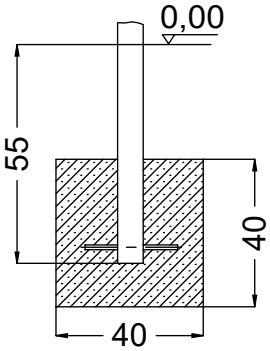

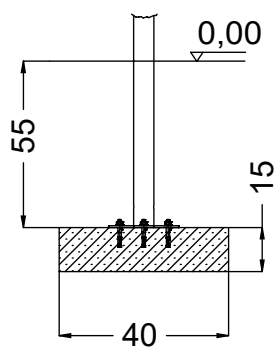

K2

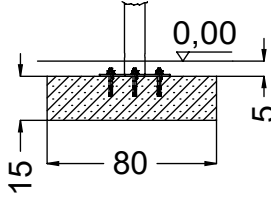

K3

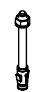
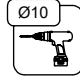

| | |
|---|---|
|  | K2, K3 |
| M10x120 x13 |  |
| NOT INCLUDED |  |

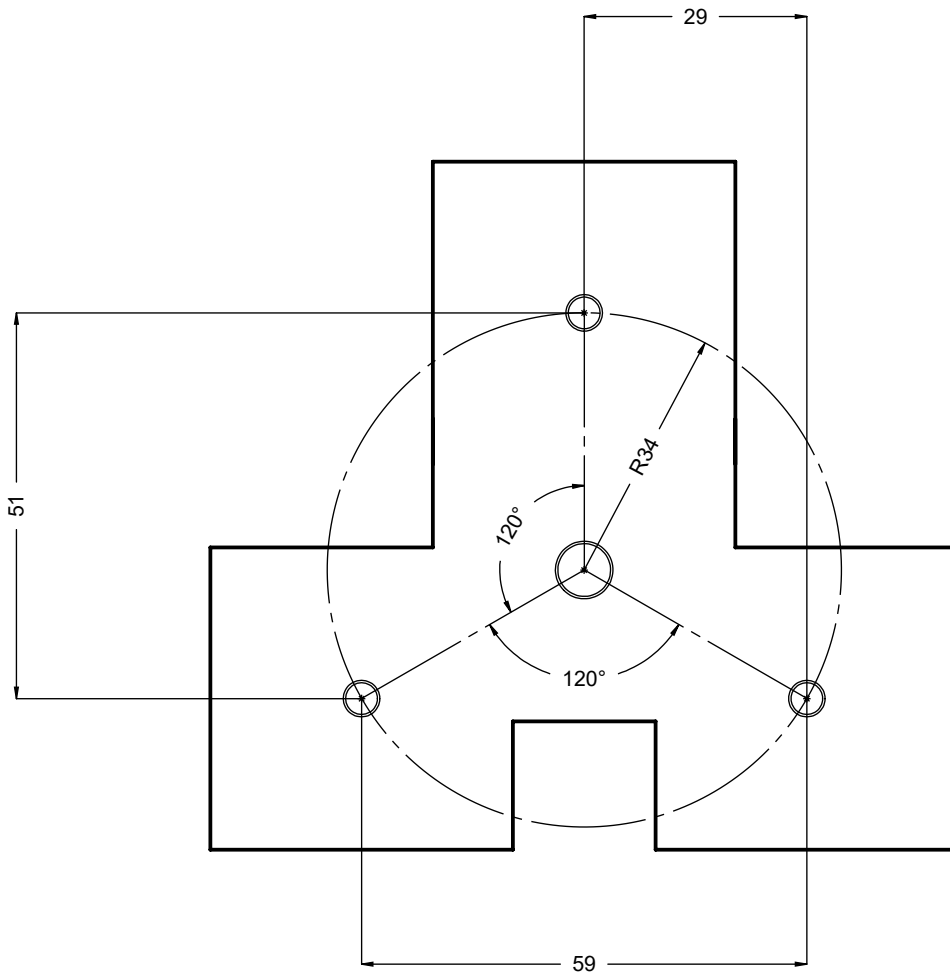

[cm]



2,0h



>0.06m³



>0.02m³



>0.24m³

play
vinici

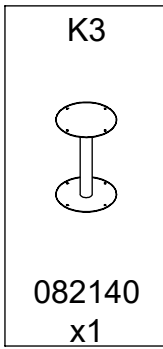
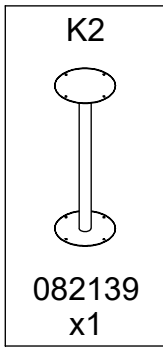
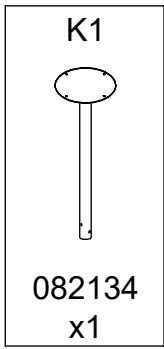
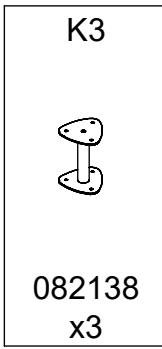
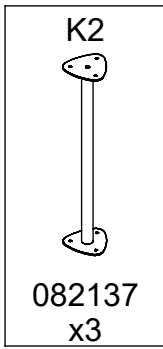
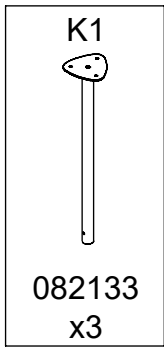

991168
x3



081207
x1

| HDPE | | HPL | |
|------|------|-----|------|
| 1x | C172 | 1x | CL44 |
| 3x | CE47 | 3x | CL47 |
| 1x | V001 | | |

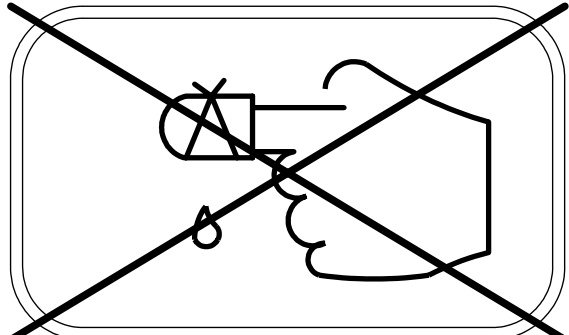
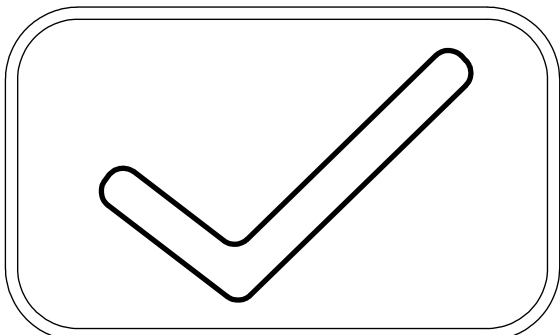
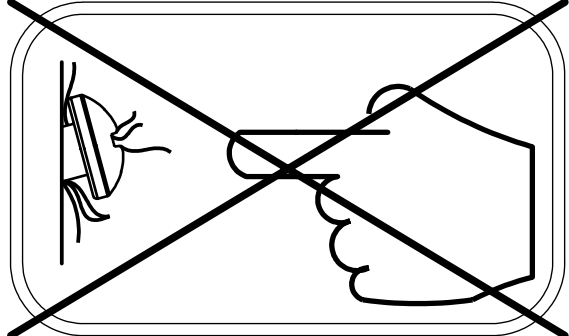
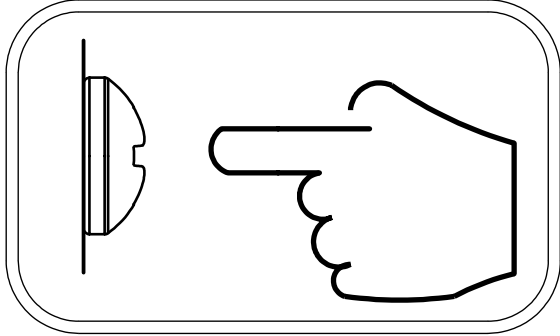
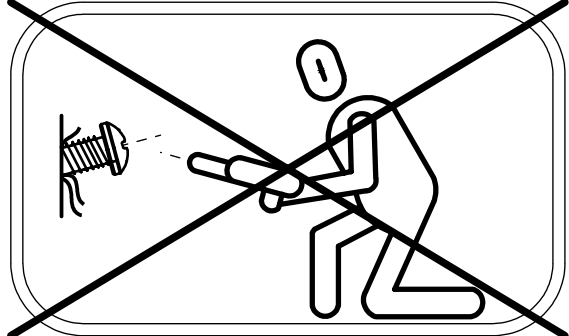
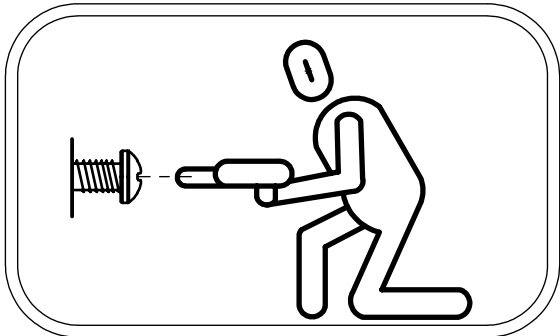

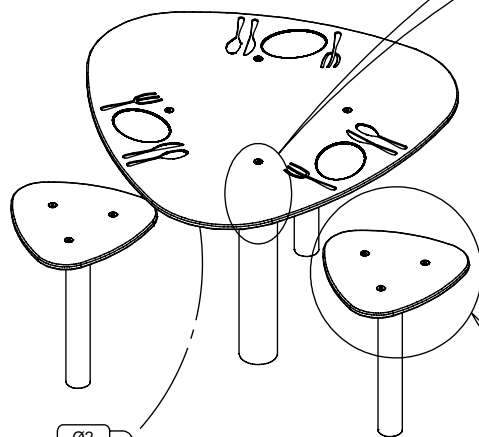
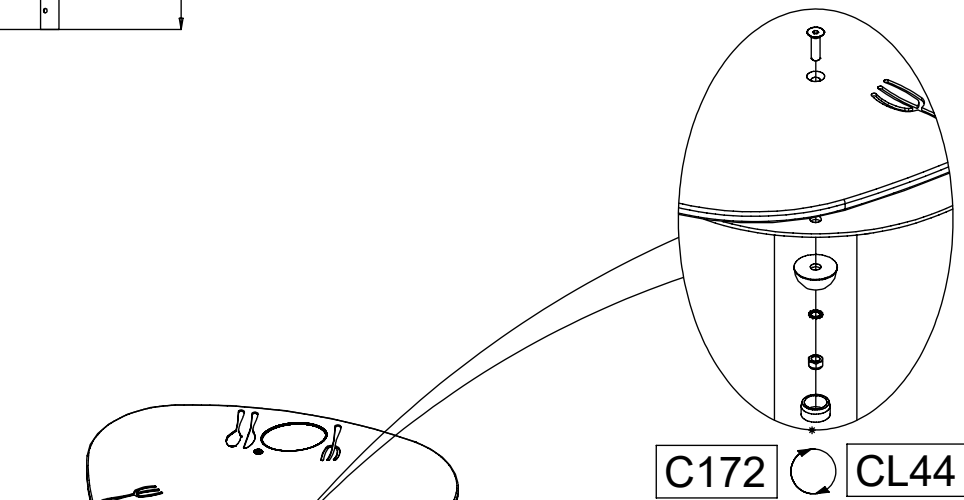
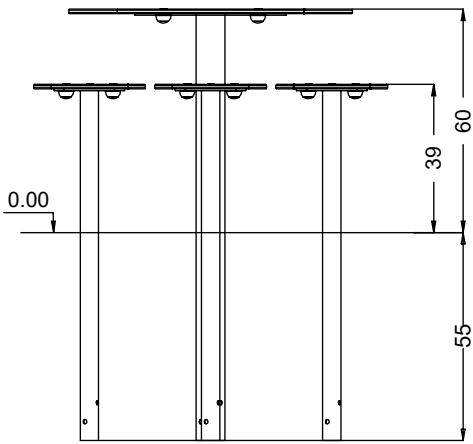

vinel
play
Art. Nr.
year
201
EN 1178-1:2017
Vinel Group Sp. z o.o.
Pogodny, ul. Kółkowska 6
05-818 Mińsk Mazowiecki
POLAND
+48 42 253 24 80
www.vinel-play.com
www.vinel-group.pl

V001



[cm]

vinel
play
vinel