



## Product technical sheet

# STEEL 0814



1 - 8 years



4 kids



14 m<sup>2</sup>



## Material specification

- Hot-dip galvanized and powder coated or powder galvanized and powder coated steel construction of 80 x 80 mm profile,
- Platforms made of durable anti-slip and waterproof plywood or HPL plate,
- Roofs, side panels made of durable HDPE or HPL plate, resistant to weather conditions,
- Screws covered with plastic caps and/or stainless steel screws,



### Facilitating disability



easy access



shelters



integration



### Intellectual development



thinking



### Physical development



hiding





**1**  
number of  
towers



**1**  
number of  
roofs



**2**  
number of interactive  
elements

## Product technical sheet

# STEEL 0814

### Product data

Length	100 cm
Width	97 cm
Total height	164 cm
Age group	1 - 8 years
Number of users	4 kids
Safety zone	14 m <sup>2</sup>
Free fall height	<60 cm
The height of the platforms	10 cm
In accordance with norm EN	1176-1:2017+A1:2023
Weight of the heaviest part	83 kg
Dimensions of the largest part	217x100x96 cm
Availability of spare parts	YES
Installation time	2 h

Color options



Data is subject to change without prior notice.

### Additional information

- equipment adapted for the disabled; intended for public playgrounds;
- equipment has a certificate issued by an accredited entity or a declaration of conformity;
- no sharp edges or chinks that would pose a danger of jamming the head, fingers or any other body parts;
- anchoring on flat surface, 80/70/60 cm deep;
- render is for reference only, the actual appearance of the equipment and its color may vary;

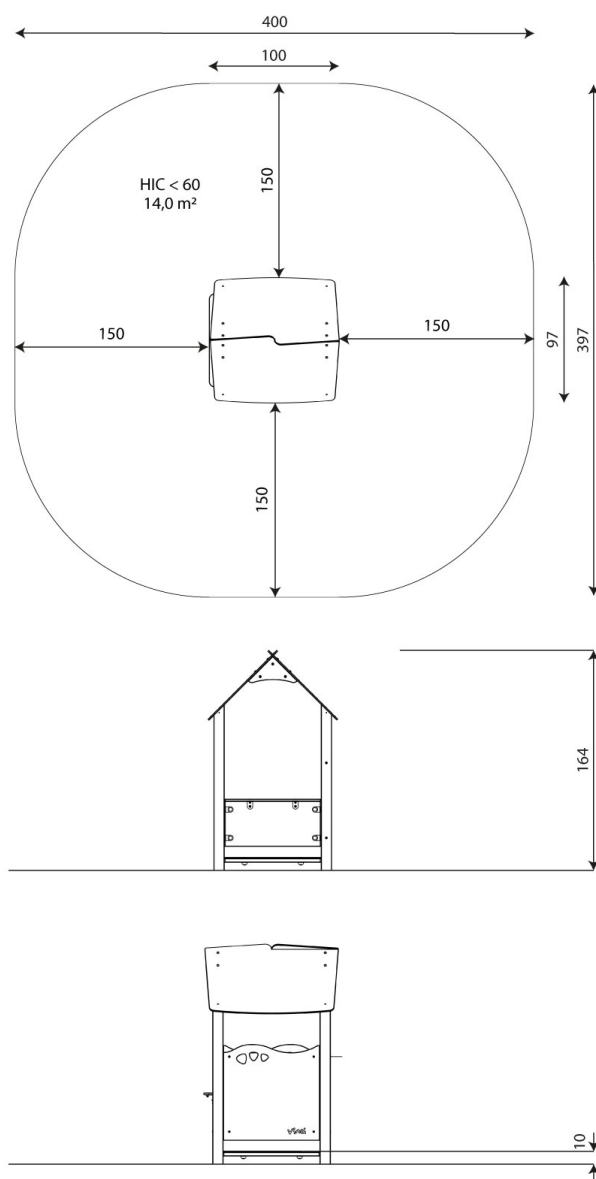

### Guarantee

**30**

30 year guarantee -  
Durability of steel and  
stainless steel  
structural elements

**15**

15 year guarantee - Durability  
of steel and stainless steel  
structures of mobile devices;  
durability of Robinia wood  
structural elements

**10**

10 year guarantee - Structural  
strength of HDPE, 100% recycled  
HDPE and HPL elements;  
structural elements made of  
100% recycled material  
(composite)

**5**

5 year guarantee - Corrosion resistance  
of stainless steel and hot-dip galvanized  
and powder-coated steel elements,  
resistance to bark beetles and rotting of  
wooden structural elements

Detailed information in the guarantee card



# STEEL 0814

## Surfaces according to EN 1176-1:2017+A1:2023

	Description (mm)	Layer thickness (cm)	Maximum fall heights (cm)
Turf/ top layer of soil (A,B,C)	-	-	≤100
bark (A,C)	Particle size from 20 to 80	30	≤200
		40	≤300
woodchips (A,C)	Particle size from 5 to 30	30	≤200
		40	≤300
sand or gravel (A,C)	Particle size from 0,25 to 8	30	≤200
		40	≤300
synthetic attested (A,B,C)	Tested according to EN 1177		60

**Amount of safe surface corresponding with free fall height:**

HIC <60 14,0 m<sup>2</sup>

Data is subject to change without prior notice.

